

S.G. No.
622/2005

Approved

S.R. Gibson
Surveyor-General
2005-04-11

COMPONENTS:

- 1) The figure ABCDhgfedba represents Remainder of Erf 10059 Durban. Vide diagram S.G. No. 1452/1957 and Certificate of Consolidated Title No. 1750/1958.
- 2) The figure abdefghEF represents Portion 1 of Erf 10059 Durban. Vide diagram S.G. No. 1453/1957 and Deed of Transfer No 1751/1958.

SERVITUDE NOTES:

- a) The line FA represents the middle line of a Party Wall Servitude 1,37m wide. Vide diagram Lease Vol. 4/1954 and Deed of Servitude No. 49/1924.
- b) The figure mga1b1 represents a Light and Air Servitude 0,91m wide. Vide diagram S.G. No. 1453/1957 and Deed of Transfer No. 1751/1958.
- c) The figure mghn represents a Sewer and Drain Servitude 0,91m wide. Vide diagram S.G. No. 1453/1957 and Deed of Transfer No. 1751/1958.
- d) The figure gqrh represents a Sewer and Drain Servitude 0,91m wide. Vide diagram S.G. No. 1453/1957 and Deed of Transfer No. 1751/1958.

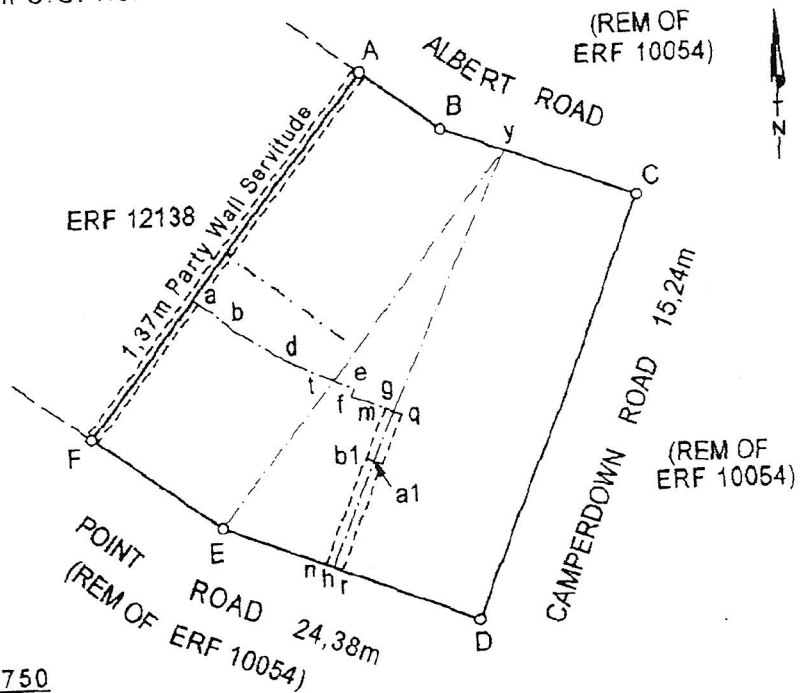

SCALE : 1 : 750

The figure represents

ABCDEF
1903 Square metres

of land, being

ERF 12554 DURBAN

(Comprising components 1 and 2 as listed above)

Situate in the eThekweni Municipality, Central Operational Entity
Registration Division - FU, Province of KwaZulu-Natal

Compiled in March 2005
by me

S.R. Gibson

S.R. Gibson (PLS - 0213)
Professional Land Surveyor

This Diagram relates to Registrar of Deeds	The original diagrams are as quoted above.	File No. /59 VOL 3 S.R. No. Compiled Comp. U37
---	--	--

124 POINT ROAD